



The art of creative living

**smart**  
slide folding doors





# Bringing the great outdoors into your home



Visofold Slide folding doors transform your home and the way you live your life; relax in stylish open plan living areas or enjoy a stunning panoramic view from your bedroom.

You will feel like you're living the outside inside by opening entire façades in your home and make the most out of a beautiful garden. Any aspiration is possible with a Visofold slide folding door. These beautifully designed, versatile doors are suitable wherever you want to transform your home; living room, bedroom, kitchen, conservatory. The choice is yours.

The modern aesthetics of a Visofold slide folding door will add a touch of finesse to any external aspect of your home. When closed, Visofold complements your home with a striking glass façade with attractive curved characteristics that are pleasing to the eye. Fold the sashes back to give a stunning opening that draws the exterior ambience into the comfort of your home.

Visofold slide folding doors come with all the assurances you would expect from a quality designed product. The aluminium profiles are designed to give strength and durability to ensure a structurally sound product that requires minimal maintenance and delivers reliable performance over a lifetime of use.

Create the perfect Visofold door styled to complement your home





# visofold

Slide folding doors

Relax and enjoy the ambience created by a Visofold slide folding door.

Visofold doors fold open effortlessly, gliding on stainless steel rollers allowing unrestricted thoroughfares and the maximum use of space and light. The signature smooth contours and curved clean lines create an attractive aesthetic that will complement any home, whatever your taste or style.







# visofold

## Slide folding doors



Visofold's aluminium sections utilise the latest polyamide thermal barrier technology. This advanced profile technology creates a thermal transmittance barrier between the cold outside and the warm inside, keeping your home warm and comfortable even in the coldest weather, helping to reduce energy bills. The sashes can be glazed with a range of double or even triple glazed sealed units up to 38mm, and threshold options are available to give improved weather performance.



Sliding sashes have the option of folding back internally or externally, with a wide choice of sash configurations. For ease of access you do not have to open the doors 100%; open in the centre like French doors, or from the side like an entrance door. Aluminium profiles are finished in polyester powder coated paint and are available in a huge range of colours and finishes that includes dual colour, realistic wood structure and metallic paint options. The polyester powder coated paint finish is produced to the highest standards and quality assured by Smart's 25 year paint finish guarantee\*.

Your home will be protected from unwelcome visitors with the assurance given by high security multi-point locking mechanisms fitted on opening sashes, shoot bolt locks on floating mullions and internally glazed sealed units.

\*Conditions apply; speak to your installer for details.

Visofold doors fold to give large opening aperture.

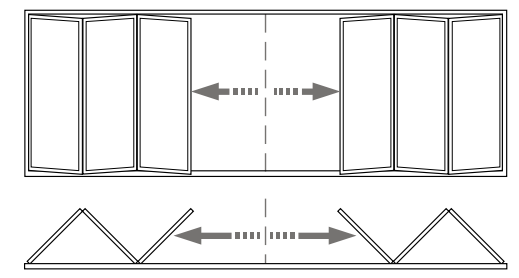

Choose to fold Visofold doors internally or externally.

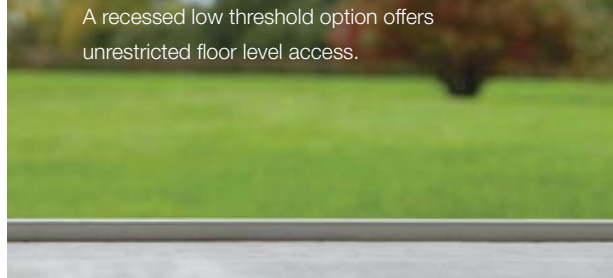
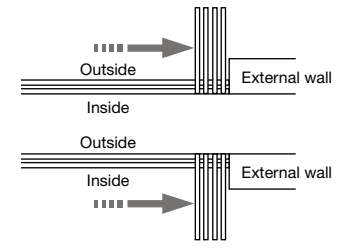

Visofold's attractive handles are available in a range of standard colours, and have the option of being colour matched to the colour of your doors, even in dual colour.

High security multi-point locks are fitted to master sashes as standard, with shoot bolt locking on all sliding mullions.

Sashes slide on four stainless steel rollers giving effortless motion, however large the door.







Enjoy beautiful views from the warmth  
and comfort of your own home

# visoglide

Performance sliding doors

A Visoglide door adds eye-catching impact to the exterior of your home. The outward appearance focuses on stunning glass areas, highlighted by bold aluminium sections styled with clean aesthetic lines that work in harmony with the character of any home.

Visoglide sliding doors deliver optimum performance and are tested to the highest standards to guarantee reliability. The strong, thermally broken aluminium sections enable the creation of dramatic sliding sashes with large glass areas without reducing thermal or weather resistance. Special sliding mechanisms enable even the largest sashes to slide open and closed smoothly, whatever their size. When closed these large sliding doors form a thermally efficient glass façade, a wonderful way to flood a space with light and enjoy beautiful views.

Visoglide's aluminium profiles are styled with an attractive modern aesthetic with signature strong lines that balance the quality of the large sashes. The thermal performance of aluminium sections is enhanced with Polyamide thermal barrier technology, enabling Visoglide doors to exceed the performance requirements of current building regulations. Sliding sashes will accept a range of glazing options, including double or triple glazed units up to 29mm.

Visoglide is available in a huge range of powder coated paint colours and finishes, including dual colour, realistic wood structure and metallic paint options. All paint finishes are produced to the highest standards and come with Smart's 25 year paint finish guarantee.\*

\*Conditions apply; speak to your installer for details.



A range of door furniture options are available in a choice of standard colours and finishes, with the option to colour match to the colour of the doors.



Shut out the cold; Visoglide doors give optimum thermal and weather performance keeping your home warm and comfortable whatever the weather.







# viso glide

Performance sliding doors



Visoglide doors are complemented by a range of furniture options featuring traditional lever/lever or 'D' looped handle options. Handles are available in a choice of choice of standard colours; with the additional option to colour match the handles to the colour of the doors.

If you desire a wider than normal opening, Visoglide doors have the option of utilising a triple track system that allows multiple sliders to open in the same direction at once, giving the potential up to two thirds opening aperture.

You can have peace of mind knowing your home security is assured with high security multi-point hook locking mechanisms fitted as standard to master sliding sashes, with the additional security of internally glazed sliding sashes.

Where an application requires a sliding door that will perform to the most extreme performance; either very large oversized apertures or the most severe weather conditions, a Superglide extreme performance sliding door offers the ideal solution. Styled with the same clean aesthetics as Visoglide, Superglide's ultra-strong aluminium sections feature an enhanced thermal barrier designed to perform under the most demanding of conditions.

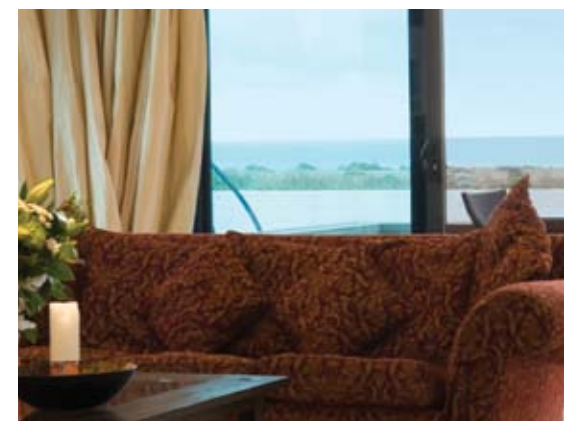

Sliding doors have large glass areas.

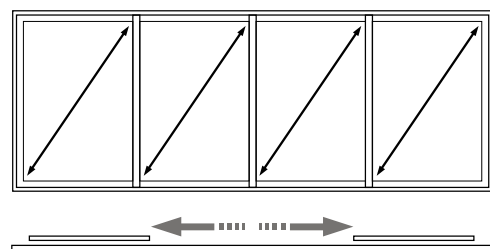

Enjoy beautiful views; the option of multiple sliding panes offers a stunning glass facade and a wider opening aperture.



The range of furniture includes traditional lever / lever handles

Multipoint hook locks are fitted as standard to opening sliders

Visoglide's sliding mechanism ensures reliable operation







# slide

## Slimline sliding doors

Enjoy sophisticated aesthetics  
that complement beautiful views

Slide doors bring a graceful elegance to the exterior aspects of your home. The slimline thermally broken sections have a subtle chic aesthetic that brings a stylish ambience to the feel of your home. Slide patio doors feature signature slimline profiles that are pleasing to the eye and make maximum use of light and space in your home.

The slim profiles feature a unique bullet nose meeting style that gives added strength to the sliding sashes enabling the doors to be ultra slim. The thin aluminium sections minimise sightlines making best possible use of the glass area. All aluminium profiles feature polyamide thermal barriers and will accept a range of glazing options up to 24mm.

Slide doors are available with a multi-track option, allowing multiple panes to slide to one side giving a potential 2/3 opening aperture.

Choose a bespoke finish to suit your home; Slide doors are available in a range of colour options including dual colour, wood structure and metallic paint finishes. All profiles are quality finished with powder coated paint, and come with Smart's 25 year paint finish guarantee\*.

\*Conditions apply; speak to your installer for further details.

Triple track option will give your sliding door a wide opening aperture.

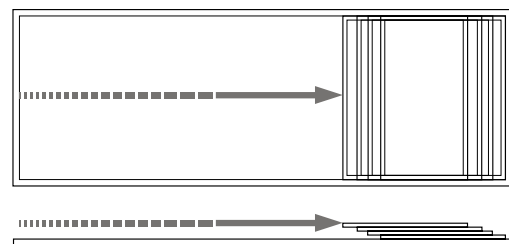

Slide doors feature signature slimline sash and sliding tracks with Polyamide thermal barriers that allow dual colour painting.



Slide doors feature handles in a range of standard colours and an attractive bullet nose meeting style.





# Relax and enjoy your home,

as the UK's leading aluminium systems company we have the expertise and range to fulfill your dreams, from traditional homes to contemporary builds.

## Design expertise

Smart Architectural Aluminium is renowned in the fenestration industry for their ethos of quality in design and development. Our expertise and reputation has been built from over 30 years experience in designing and supplying quality assured aluminium profile systems to the window and door industry. It is this experience and reputation for excellence that has made Smart Architectural Aluminium the UK's leading supplier of aluminium windows & door systems.

Located in Yatton, North Somerset, at purpose built 120,000 sq/ft offices and manufacturing plant the company has an annual turnover in excess of £30 million and employs over 100 people. Smart's has a nationwide delivery service with their own dedicated transport fleet that make daily deliveries to its network of reputable fabricators throughout the UK.

## Installation

Smart's products are available via a network of reputable window and door fabricators throughout the UK who carry out installation in accordance with best practices. You can obtain a list of the nearest Smart Installers in your area from our website:

[www.smartsystems.co.uk/consumers/](http://www.smartsystems.co.uk/consumers/)



## Assurance of quality

Smart Architectural Aluminium operates an extensive testing regime to ensure that our products continue to perform to the highest standards. In our view, quality implies consistency, reliability and durability in terms of materials, product performance and service. It is for these reasons that we fully support independent certification and assessment schemes such as those offered by the British Standards Institute.

## Environment

Smart Architectural Aluminium is committed to working towards a sustainable working environment, and to ensuring that every aspect of our activities is conducted in accordance with sound environmental practices.



Quality Standards:



Council for Aluminium  
in Building  
Member

We reserve the right to make changes to the product specification as technical developments dictate, and without prior notice.

Pictures shown in this brochure are for illustrative purposes and are not binding in detail, colour or specification. ©Smart Systems Ltd 2008



**Mixed Sources**  
Product group from well-managed  
forests, and other controlled sources  
[www.fsc.org](http://www.fsc.org) Cert no. TT-COC-002530  
© 1996 Forest Stewardship Council

# Bringing the great outdoors into your home





smart

The art of creative living

**smart**  
slide folding doors

Smart Systems Limited  
Arnolds Way, Yatton, North Somerset BS49 4QN. UK  
Tel +44 (0)1934 876 100 Fax +44 (0)1934 835 169  
sales@smartsystems.co.uk www.smartsystems.co.uk